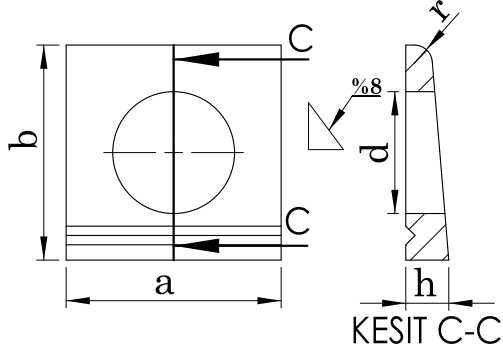

DIN 435**KONİK 4 KÖŞE "I" RONDELA
SQUARE TAPER WASHERS FOR USE WITH "I" SECTIONS
SCHEIBEN VIERKANT FÜR I-TRAGER****Technical Informations / Teknik Bilgiler**

	M8	M10	M12	M16	M20	M22	M24
d	9,00	11,00	13,50	17,50	22,00	24,00	26,00
a	22,00	22,00	26,00	32,00	40,00	44,00	56,00
b	22,00	22,00	30,00	36,00	44,00	50,00	56,00
h	3,80	3,80	4,90	5,90	7,00	8,00	8,50
r	1,20	1,20	1,60	2,00	2,40	2,40	2,40
Diameter /Çap	8,00	10,00	12,00	16,00	20,00	22,00	24,00
gr/p	10,10	9,40	20,10	35,60	67,00	90,00	143,00

Values are given in millimeters. / Değerler milimetre olarak verilmiştir.